

# \$179,900 - Se-15-73-5-w6 Range Road 52, Rural Grande Prairie No. 1, County of

---

MLS® #A2199434

**\$179,900**

0 Bedroom, 0.00 Bathroom,  
Land on 10.01 Acres

NONE, Rural Grande Prairie No. 1, County of,  
Alberta

Rare opportunity to own a larger parcel of land at an affordable price! This 10+ acre parcel is located a short drive out of GP. There's a great opportunity to set this property up for your business or for animals! CR-5 ZONING! Owner may be willing to finance while the acreage is being set up giving you financial flexibility to make your dreams come true.

## Essential Information

MLS® #	A2199434
Price	\$179,900
Bathrooms	0.00
Acres	10.01
Type	Land
Sub-Type	Residential Land
Status	Active

## Community Information

Address	Se-15-73-5-w6 Range Road 52
Subdivision	NONE
City	Rural Grande Prairie No. 1, County of
County	Grande Prairie No. 1, County of
Province	Alberta
Postal Code	T0H 3C0

## Additional Information

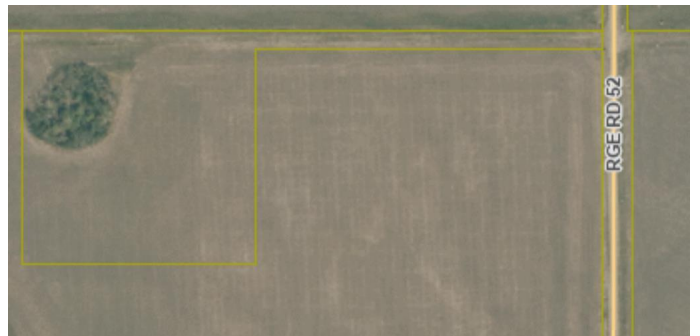

Date Listed	March 5th, 2025
Days on Market	68
Zoning	CR-5

## **Listing Details**

Listing Office	Grassroots Realty Group Ltd.
----------------	------------------------------

Data is supplied by Pillar 9â„¢ MLS® System. Pillar 9â„¢ is the owner of the copyright in its MLS® System. Data is deemed reliable but is not guaranteed accurate by Pillar 9â„¢. The trademarks MLS®, Multiple Listing Service® and the associated logos are owned by The Canadian Real Estate Association (CREA) and identify the quality of services provided by real estate professionals who are members of CREA. Used under license.